

Accessories

Split-core Current Transformer, 1-Phase AC

Type SCT74/30



- Split-core current transformer
- Cable/bus-bar type current transformer
- 5A (1A on request) secondary current
- Screws and nuts for busbar mounting

Product Description

These split core current transformers can be used for currents from 100A to 400A. The current transformers are made according to BS3938, EN60044-1 and DIN42600 standards.

Ordering Key

SCT7430 2005A C1

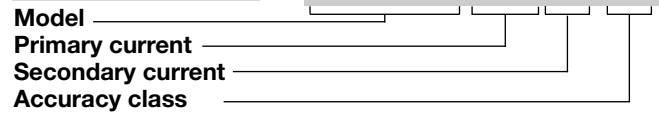

Type Selection

| Model SCT7430 | Primary Current | Secondary current | Accuracy class |
|--------------------------|----------------------|-----------------------|---|
| Bus-bar size: 31 x 26 mm | Refer to Range Table | 5A 1A (on request) | 1 ... 3 (see table) 0.5 (on request) |

Input Specifications

| | |
|---------------------------|--|
| Operating frequency | 50 to 60 Hz |
| Max. system voltage | 0.72 kV |
| Rated insulation level | 4kV _{RMS} , 50Hz, 1 min |
| Short-time current rating | 60 I _n 2.5 x I _{th} |
| Extended current rating | 120% |
| Security factor (FS) | 5, 10 |

General Specifications

| | |
|---------------------------|---|
| Insulation class | E (MAX 120°C) |
| Protection | IP00 |
| Working temperature range | -20 to 45°C |
| Storage temperature | -50 to 80°C |
| Standards | According to BS3938, EN60044-1 and DIN42600 |
| Connection | The secondary terminals have two connections on each side. Connection with M4 (M5) screws easy to handle and securing low contact resistance. |
| Housing | ABS, self-extinguishing: UL 94 V-0 |
| Mounting | DIN-rail/bus-bar and panel mounting (bracket supplied with the CT) |
| Standard accessories | Screw and nut for busbar mounting |
| Accessories on request | Clip, for DIN EN50022 rail |
| Special features | The terminal cover is fitted for a lead seal. This execution complies with the VGB4 protection of DIN57106 standard. |
| Cable diameter | Max. 26 mm |
| Bus-bar size | 31 x 26 mm |

Output Specifications

| | |
|-------------------------|----------------------------------|
| Rated secondary current | 5 A standard 1 A (on request) |
|-------------------------|----------------------------------|

Range Table

| Rated Primary Current | Rated secondary current 5 A (1 A on request) | | |
|-----------------------|--|----------------|----------------------|
| | Class 1 Burden | Class 3 Burden | Class 0.5 (*) Burden |
| 100 A | - | 1.5 VA | - |
| 125 A | 1.5 VA | - | - |
| 150 A | - | 2.5 VA | - |
| 200 A | 1.5 VA | 5 VA | - |
| 250 A | 1.5 VA | 5 VA | - |
| 300 A | 1.5 VA | 7.5 VA | - |
| 400 A | 5 VA | 10 VA | 1.5 VA |

* On request

Dimensions (mm)

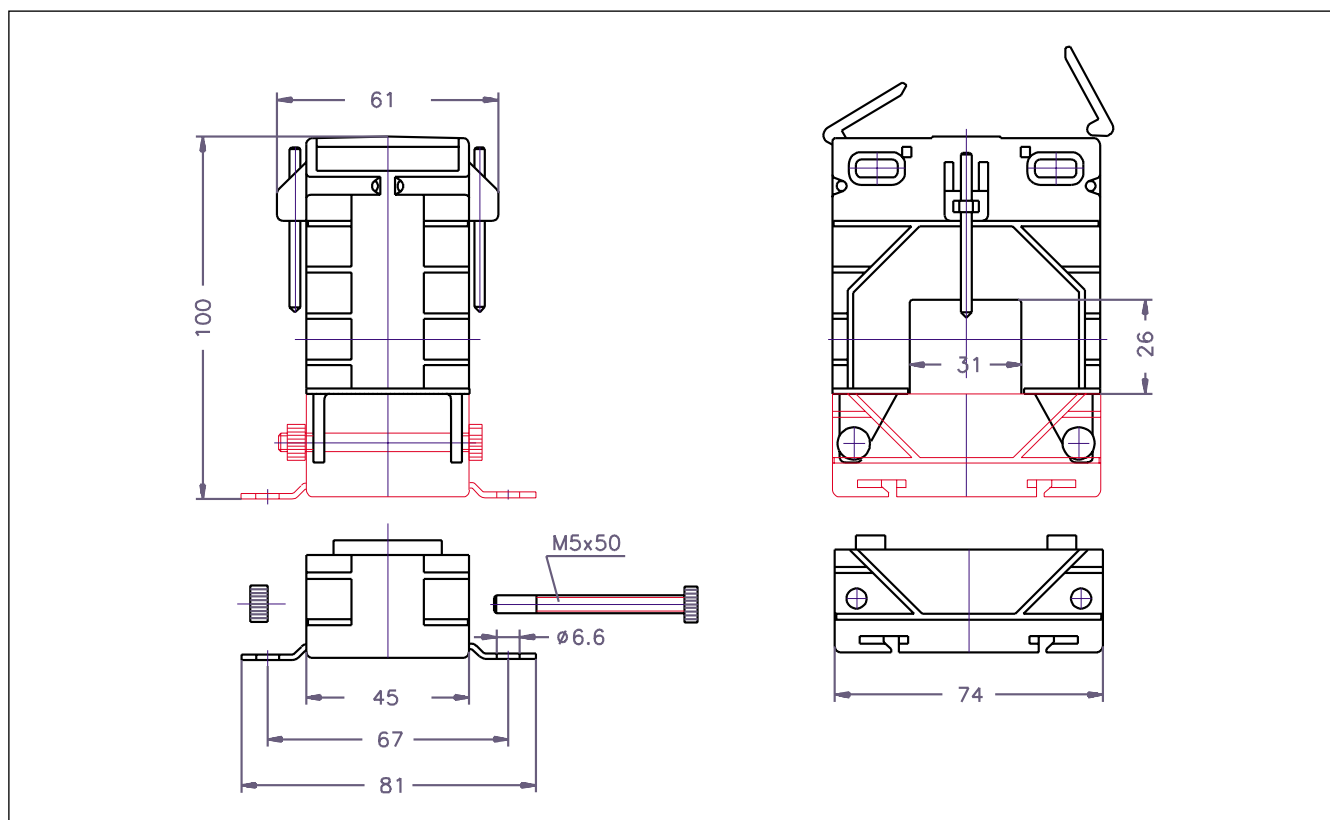

Wiring Diagram

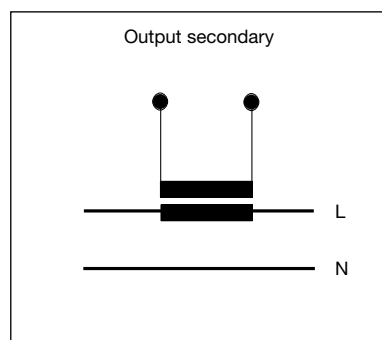

Standard and optional Accessories

Screws and nuts for busbar mounting (standard) and clip for DIN EN50022 rail mounting (on request).

